

Economic Point Model No. 8-0573

Main Features

- Pivots through 180°
- Manufactured from forged alloy steel, quenched and tempered
- Manufactured and tested in accordance with EN1677-1
- Load rated parts are 100 % magnaflux crack detected
- Individual forged parts are traceable to Test Certification
- Proof tested to 2.5 times the WLL
- Fatigue rated to 1.5 times the WLL
- All YOKE Lifting points meet or exceed all the requirements of ASME B30.26
- WLL forged onto each product for quick and easy identification
- Lugs designed to assist the welding process



Certification:

Each unit comes fully certified with a test certificate or an EC Declaration of Conformity stating compliance with the essential health and safety requirements of the Machinery Directive 2006/42/EC, the Supply of Machinery (Safety) Regulations 2008 and Section 6 of the Health and Safety at Work Etc Act 1974.

Manufactured and tested in accordance with EN1677-1. All YOKE Lifting points meet or exceed all the requirements of ASME B30.26.

Technical Data

Product Code	Capacity (tonne)	Dimensions (mm)												Net Weight (kg)
		A	B	C	D	E	F	G	H	L	W	HV	a	
8-0573-01	1.0	83	41	48	14	14	84	25	59	108	46	5	3	0.5
8-0573-03	3.0	98	48	58	17	17	84	31	53	114	54	6	3	0.9
8-0573-05	5.0	120	63	66	22	22	117	39	78	154	56	7	3	1.3
8-0573-08	8.0	121	73	68	26	26	120	47	73	166	55	10	4	2.6
8-0573-10	10.0	146	73	82	20	30	139	47	92	189	70	10	4	2.8
8-0573-20	20.0	186	93	100	25	37	175	70	105	234	91	20	4	6.5
8-0573-30	30.0	254	116	150	35	45	241	84	157	317	127	20	4	17.2

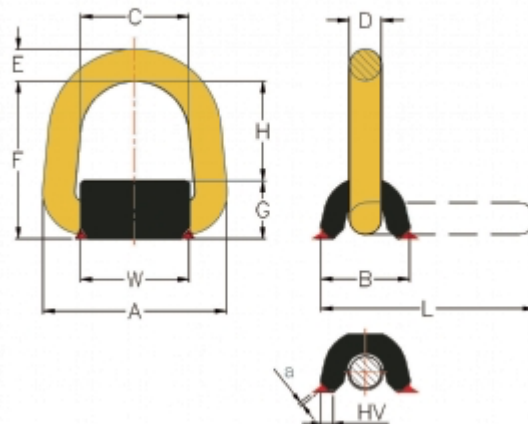

Due to our policy of continual product development, dimensions, weights and specifications may change without prior notice. Please check with your Tiger sales team when ordering.

Our innovation, your safety