

## G80 Connecting Link Model No. 8-M015



### Main Features

- Design factor 4:1 proof tested and certified

### Certification:

Each unit comes fully certified with a test certificate or an EC Declaration of Conformity stating compliance with the essential health and safety requirements of the Machinery Directive 2006/42/EC, the Supply of Machinery (Safety) Regulations 2008 and Section 6 of the Health and Safety at Work Etc Act 1974.

Manufactured and tested in accordance with EN1677-1. All YOKE Lifting points meet or exceed all the requirements of ASME B30.26.



### Technical Data

Product Code	Capacity (tonne)	For Grade 80 Chain	Dimensions (mm)				Net Weight (kg)
			A	B	D	K	
8-M015-07	2.0	7, 8	18	22	9	57	0.16
8-M015-10	3.15	10	25	26	11	68	0.3
8-M015-13	5.3	13	30	35	16	91	0.7
8-M015-16	8.0	16	36	38	19	100	1.2
8-M015-20	12.5	18, 20	42	46	22	122	1.9
8-M015-22	15.0	22	49	59	24	152	3.0
8-M015-26	21.2	26	55	62	30	162	4.6
8-M015-32	31.5	32	69	79	36	202	8.5

Other sizes available - please ask for details.

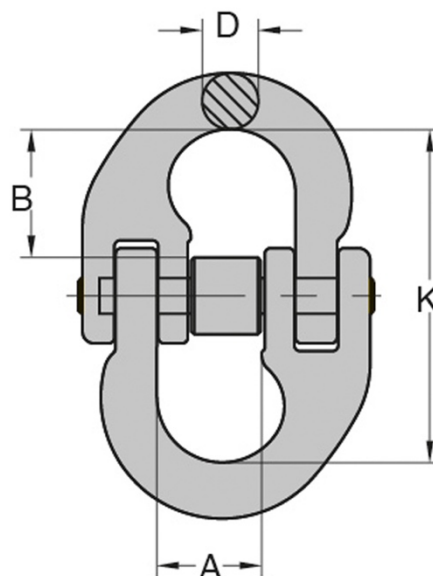

Due to our policy of continual product development, dimensions, weights and specifications may change without prior notice. Please check with your Tiger sales team when ordering.