

## Digital Anchor Point - UNC Thread Model No. 8-232

### Main Features

- Rotates through 360° and pivot 180°, and simultaneously allows lifting from any direction
- Manufactured from forged alloy steel, quenched and tempered
- Tested in accordance with EN1677-1
- Load rated parts are 100 % magnaflux crack detected
- Individual forged parts and cap screw are traceable to Test Certification
- Bolts are UNC thread
- Proof tested to 2.5 times the WLL
- Fatigue rated to 20,000 cycles at 1.5 times the WLL
- All YOKE Lifting points meet or exceed all the requirements of ASME B30.26
- Quick and simple assembly, just a tapped hole is required



### Certification:

Each unit comes fully certified with a test certificate or an EC Declaration of Conformity stating compliance with the essential health and safety requirements of the Machinery Directive 2006/42/EC, the Supply of Machinery (Safety) Regulations 2008 and Section 6 of the Health and Safety at Work Etc Act 1974.

Manufactured and tested in accordance with EN1677-1. All YOKE Lifting points meet or exceed all the requirements of ASME B30.26.

### Technical Data

| Product Code | Capacity (tonne) | Thread version |          |        | Dimensions (inch) |      |      |      |      |      |      |      |       |        |      |      | Torque in (Nm) | Net Weight (lbs) |
|--------------|------------------|----------------|----------|--------|-------------------|------|------|------|------|------|------|------|-------|--------|------|------|----------------|------------------|
|              |                  | M (inch)       | E (inch) | TPI    | A                 | B    | C    | D    | F    | G    | H    | R    | S     | SW     | I    |      |                |                  |
| 8-232-010    | 0.80             | 1/2            | 0.81     | 13UNC  | 1.30              | 1.55 | 1.20 | 0.41 | 3.16 | 2.29 | 0.91 | 0.67 | 5/16  | 3/4    | 1.72 | 100  | 0.6            |                  |
| 8-232-020    | 1.60             | 5/8            | 1.14     | 11UNC  | 1.97              | 2.14 | 1.81 | 0.65 | 4.56 | 3.54 | 1.42 | 1.06 | 3/8   | 15/16  | 2.48 | 150  | 2.0            |                  |
| 8-232-030    | 2.40             | 3/4            | 1.54     | 10UNC  | 2.01              | 2.06 | 1.89 | 0.65 | 4.56 | 3.54 | 1.44 | 1.06 | 1/2   | 1 1/8  | 2.46 | 250  | 2.1            |                  |
| 8-232-038    | 3.00             | 7/8            | 1.42     | 9UNC   | 2.81              | 3.24 | 2.28 | 0.98 | 6.42 | 4.94 | 1.75 | 1.47 | 5/8   | 1 5/16 | 3.45 | 300  | 5.0            |                  |
| 8-232-050    | 4.00             | 1              | 1.61     | 8UNC   | 2.81              | 3.18 | 2.34 | 0.98 | 6.42 | 4.94 | 1.75 | 1.47 | 5/8   | 1 1/2  | 3.45 | 400  | 3.4            |                  |
| 8-232-078    | 6.25             | 1 1/4          | 2.09     | 7UNC   | 3.43              | 3.65 | 3.23 | 1.16 | 8.02 | 5.82 | 2.44 | 1.79 | 7/8   | 1 7/8  | 4.31 | 500  | 11.2           |                  |
| 8-232-125    | 10.00            | 1 1/2          | 2.40     | 6UNC   | 4.29              | 4.38 | 4.05 | 1.42 | 9.92 | 7.40 | 3.11 | 2.22 | 1     | 2 1/4  | 5.04 | 800  | 22.3           |                  |
| 8-232-200    | 16.00            | 2              | 2.99     | 4.5UNC | 4.61              | 3.84 | 4.53 | 1.42 | 9.93 | 7.71 | 3.35 | 2.38 | 1 1/4 | 3      | 4.88 | 2000 | 28.7           |                  |

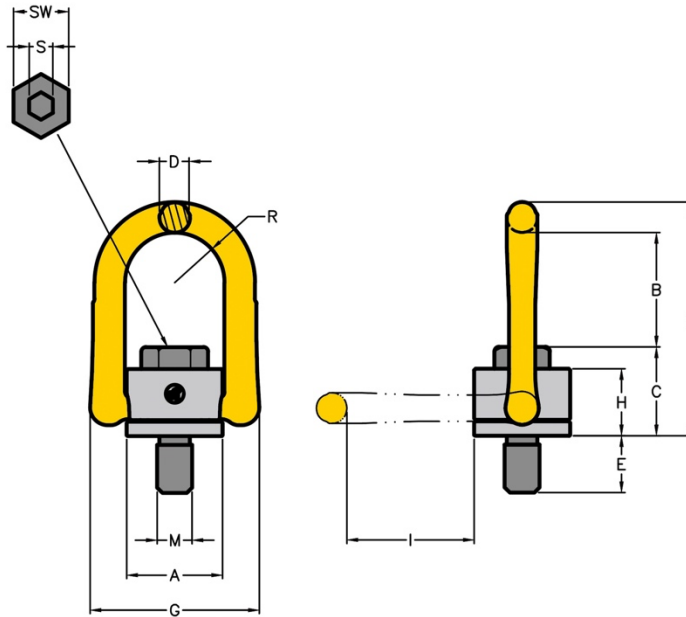

Kind of attachment

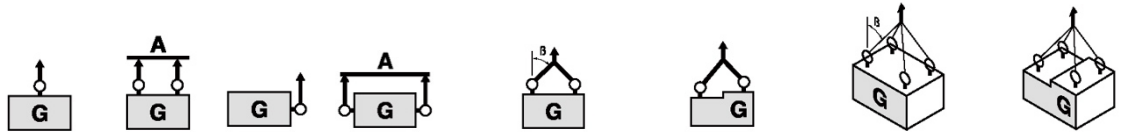

| Number of legs | 1      | 2       | 1    | 2     | 2     | 2       | 2       | 2     | 3-4     | 3-4     | 3-4   |
|----------------|--------|---------|------|-------|-------|---------|---------|-------|---------|---------|-------|
| Load direction | 0°     | 0°      | 90°  | 90°   | 0-45° | 45°-60° | unsymm. | 0-45° | 45°-60° | unsymm. |       |
| Product Code   | Thread | WLL (t) |      |       |       |         |         |       |         |         |       |
| 8-232-010      | 1/2    | 1.2     | 2.4  | 0.80  | 1.6   | 1.12    | 0.80    | 0.80  | 1.68    | 1.20    | 0.80  |
| 8-232-020      | 5/8    | 2.6     | 5.2  | 1.60  | 3.2   | 2.24    | 1.60    | 1.60  | 3.36    | 2.40    | 1.60  |
| 8-232-030      | 3/4    | 3.6     | 7.2  | 2.40  | 4.8   | 3.36    | 2.40    | 2.40  | 5.04    | 3.60    | 2.40  |
| 8-232-038      | 7/8    | 4.5     | 9.0  | 3.00  | 6.0   | 4.20    | 3.00    | 3.00  | 6.30    | 4.50    | 3.00  |
| 8-232-050      | 1      | 7.2     | 14.4 | 4.00  | 8.0   | 5.60    | 4.00    | 4.00  | 8.40    | 6.00    | 4.00  |
| 8-232-078      | 1 1/4  | 9.6     | 19.2 | 6.25  | 12.5  | 8.75    | 6.25    | 6.25  | 13.13   | 9.38    | 6.25  |
| 8-232-125      | 1 1/2  | 11.0    | 22.0 | 10.00 | 20.0  | 14.00   | 10.00   | 10.00 | 21.00   | 15.00   | 10.00 |
| 8-232-200      | 2      | 16.0    | 32.0 | 16.00 | 32.0  | 22.40   | 16.00   | 16.00 | 33.60   | 24.00   | 16.00 |

Due to our policy of continual product development, dimensions, weights and specifications may change without prior notice. Please check with your Tiger sales team when ordering.